

1 Alcott Close, Warwick
£1,600 Per Month

charlesrose.

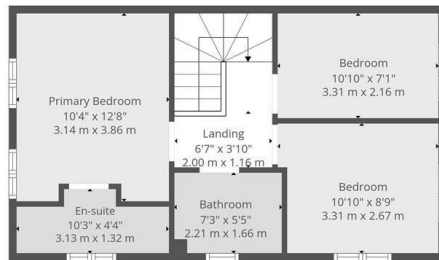

2nd Floor

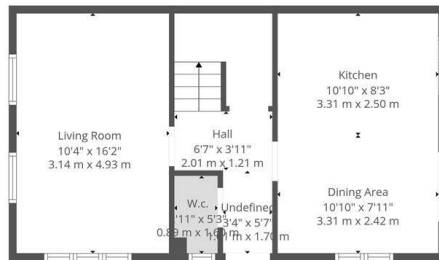

1st Floor

Total: 920 sq. Ft. 86 m2
1st Floor: 460 sq. Ft, 43 m2, 2nd Floor: 460 sq. Ft, 43 m2
Excluded Areas: Walls: 76 sq. Ft, 6 m2

Floor Plan Created By Cubicasa App. Measurements Deemed Highly Reliable But Not Guaranteed.



A well presented, three bedroom property situated in a popular residential area known for its proximity to local amenities, schools, and transportation links.

This modern home offers generous living space throughout and benefits from a large rear garden with patio and low maintenance astro turf. There is a garage included as well as a private driveway, with space for 2 - 3 cars and more parking is available on street if required.

The modern kitchen is large and finished to a high standard and includes integrated appliances, with ample space for a dining area just by the French doors which open out onto the garden patio.

The property also features two bathrooms upstairs along with a convenient downstairs WC. Ideal for families or professionals, the home is well sized and finished to a modern standard.

Unfurnished.
EPC Rating TBC
Council Tax Band D

Holding Deposit £360
Security Deposit £1840

charlesrose.

- 01926 832411
- hello@charlesrose.co.uk
- charlesrose.co.uk

